

# *irmscher*

## Anbauanleitung

Nachdruck und jegliche Art der Vervielfältigung dieser Anbauanleitung, auch auszugsweise, sind untersagt. Zuwiderhandlungen werden gerichtlich verfolgt.

***irmscher*** GmbH

D-73630 Remshalden • Tel.: 07151/971-300 • Fax.: 07151/971-305

### **QUALITY MANAGEMENT**

---

Certificate

Voluntary participation in regular monitoring according to  
ISO 9001, QS 9000, VDA 6.1.



**3280** / Stand 02.04

ANBAUANLEITUNG  
FITTING INSTRUCTION  
INSTRUCTIONS DE POSE  
INSTRUCCIONES DE MONTAJE

95 17 451

95 17 452

95 17 453

95 17 454

95 17 613

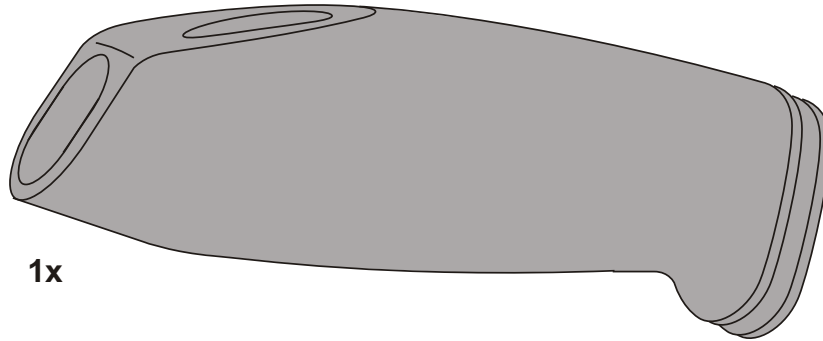

1x

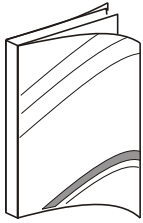

1x

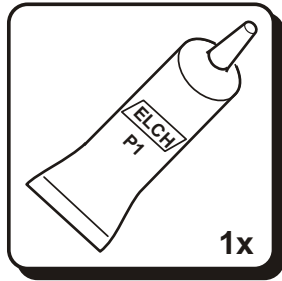

1x

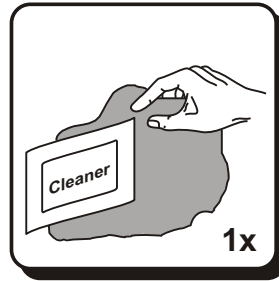

1x



1x



1x

1

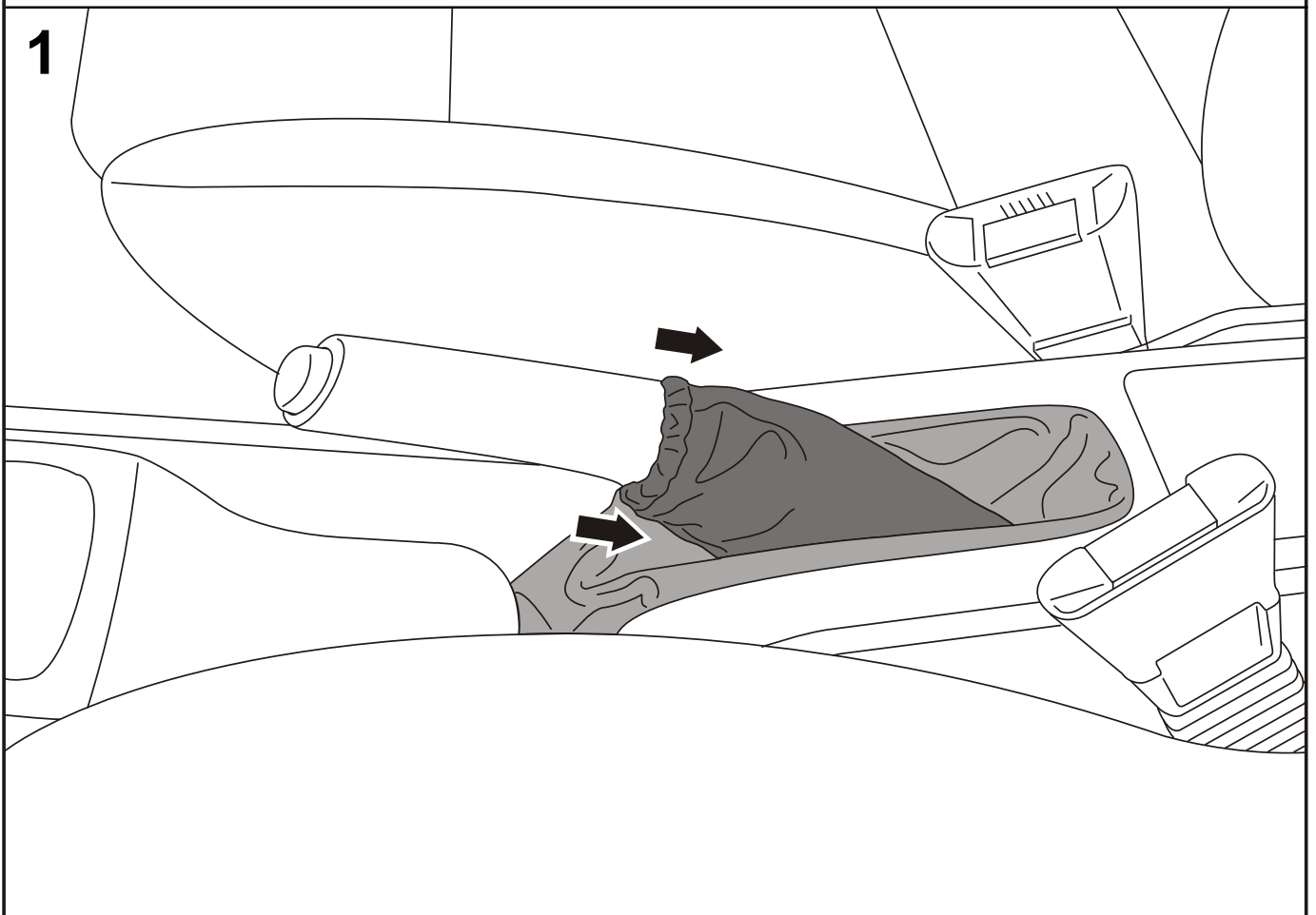

**2a**

Nur/ only Astra- G/ Astra- G Coupé/ Zafira- A

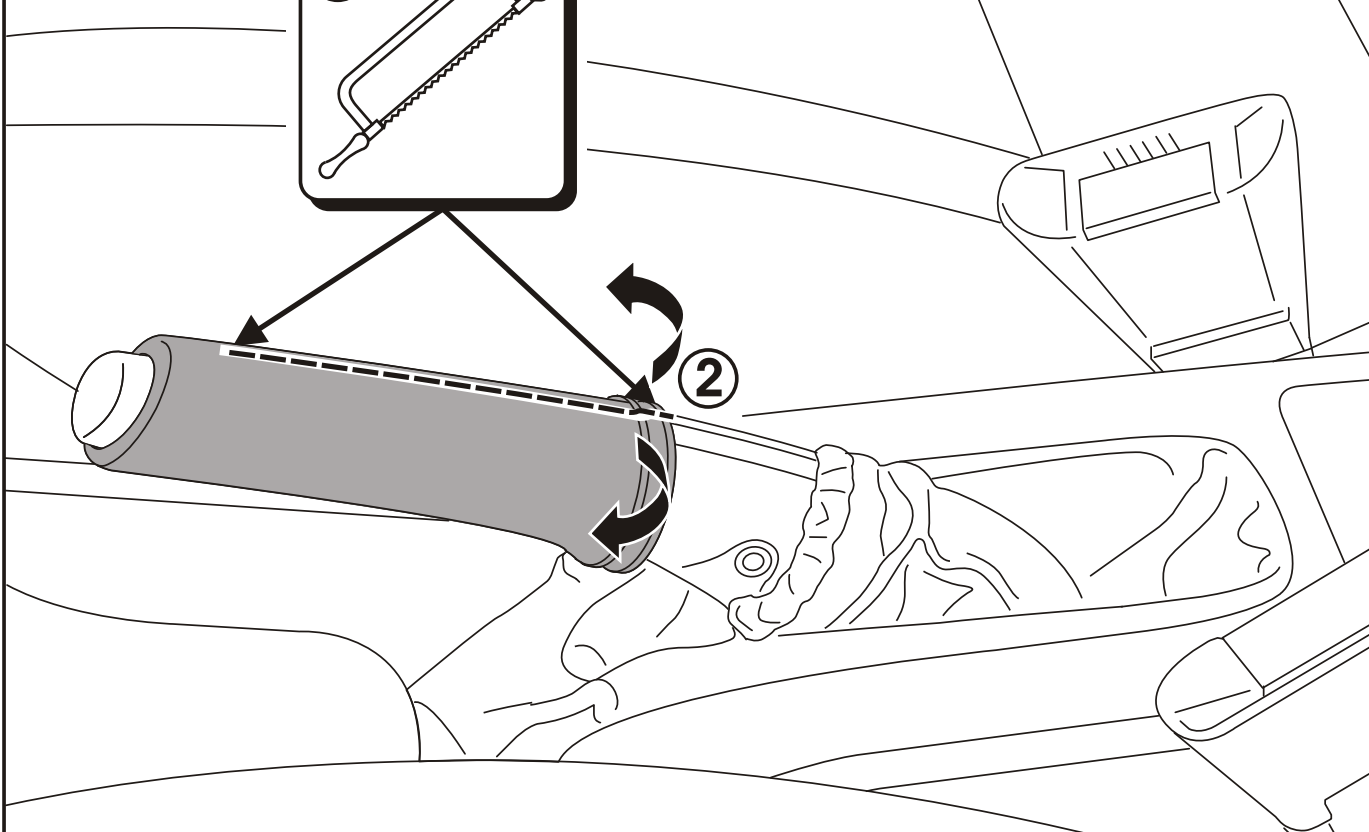
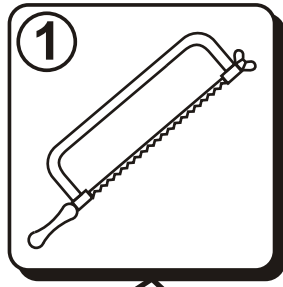

**2b**

Nur/ only Astra- H

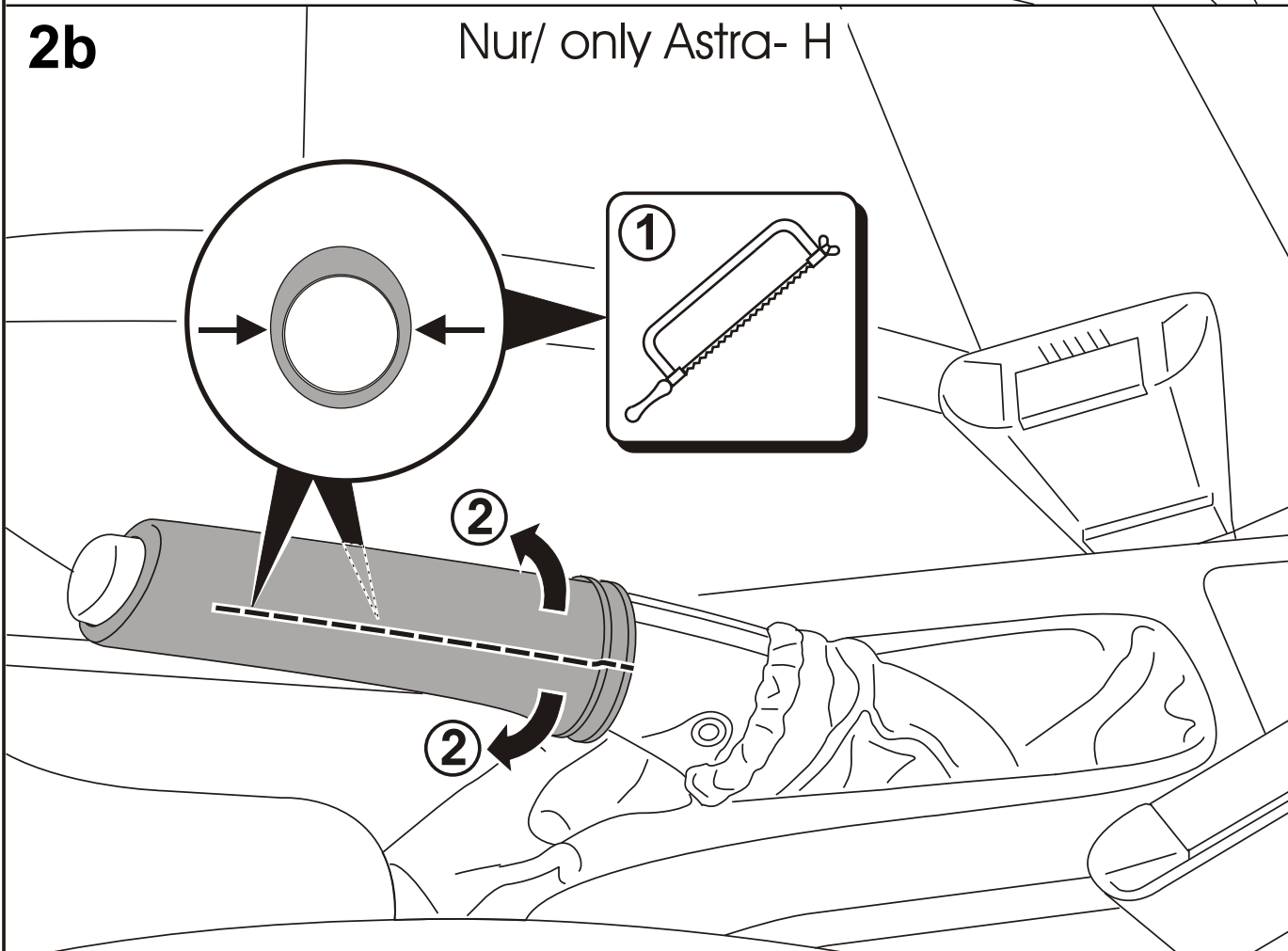
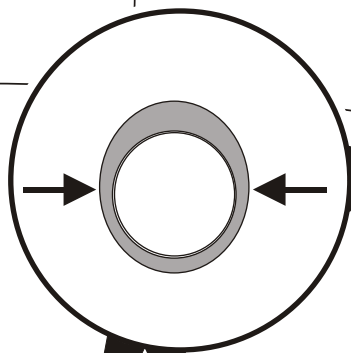
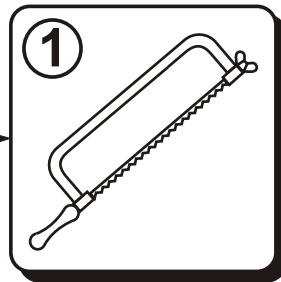

3

Nur/ only Astra- H

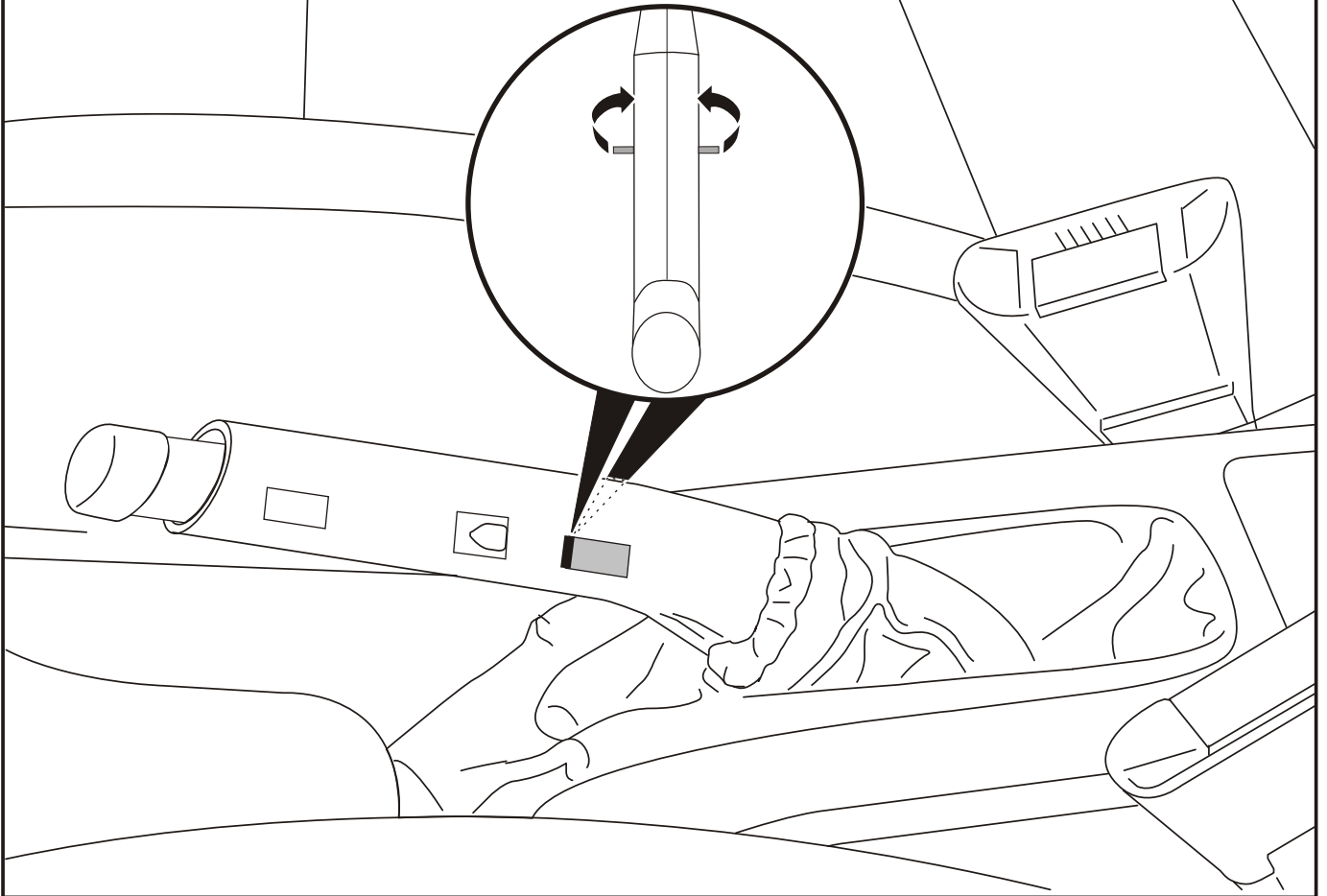

4

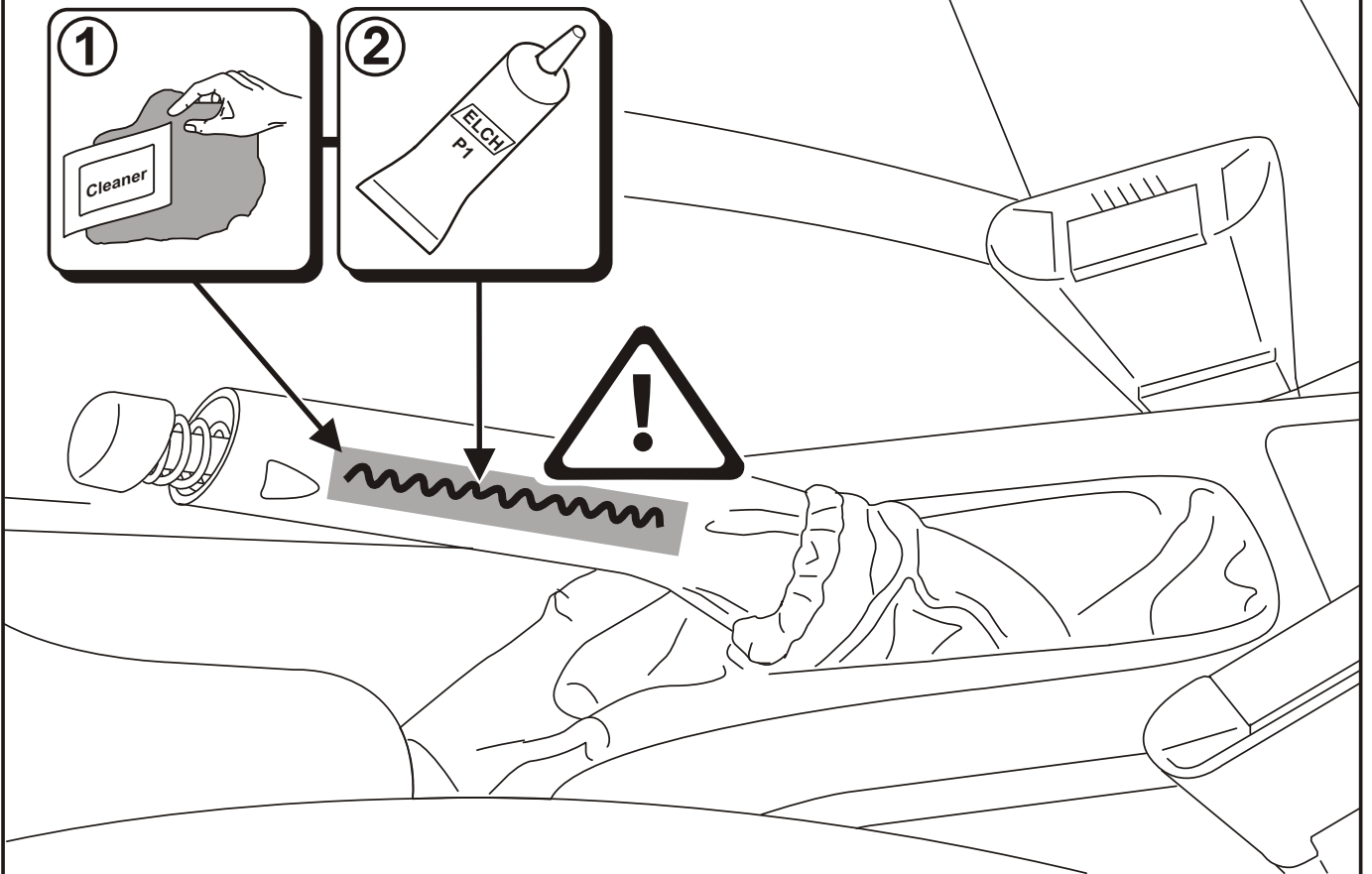

4

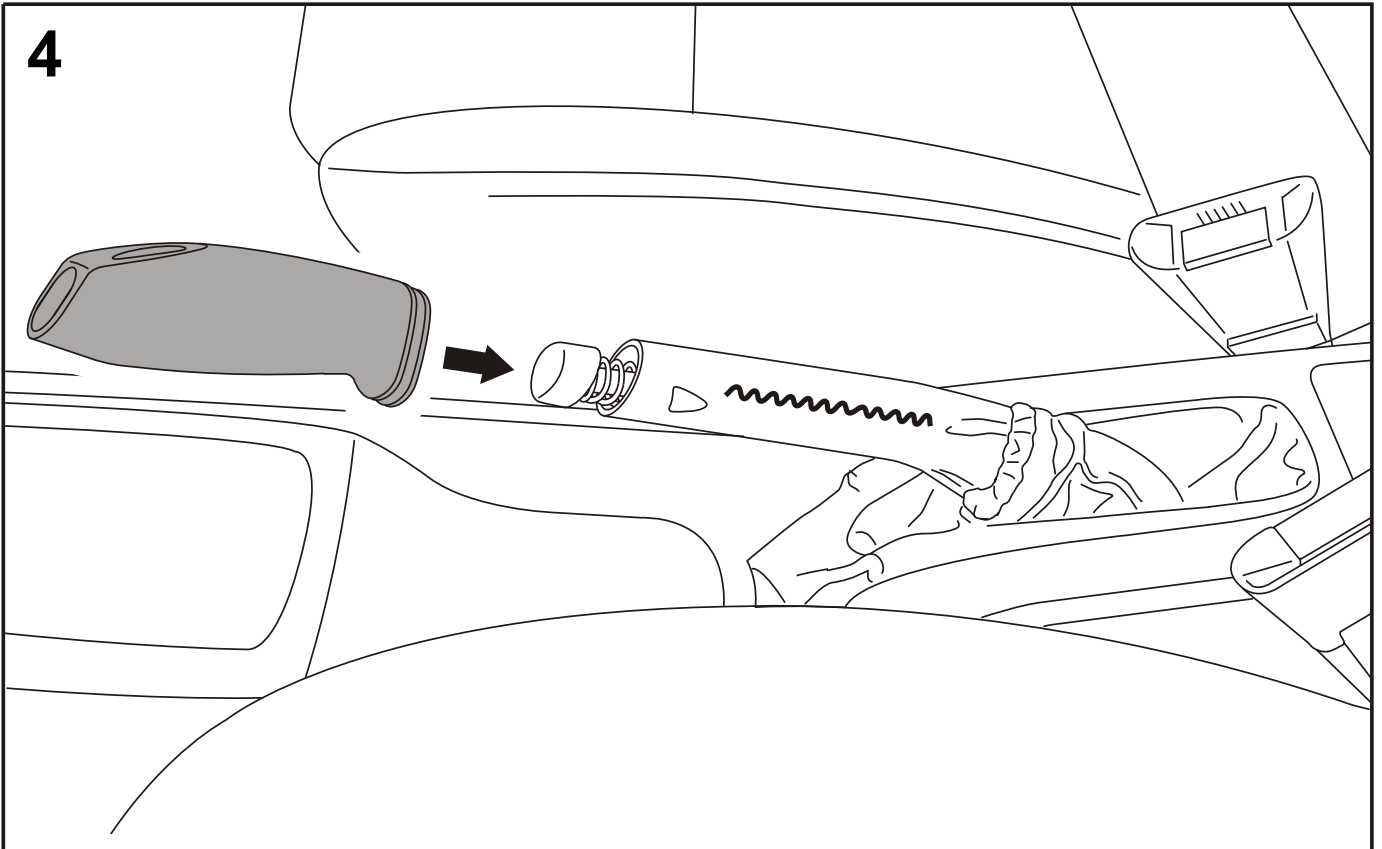

5

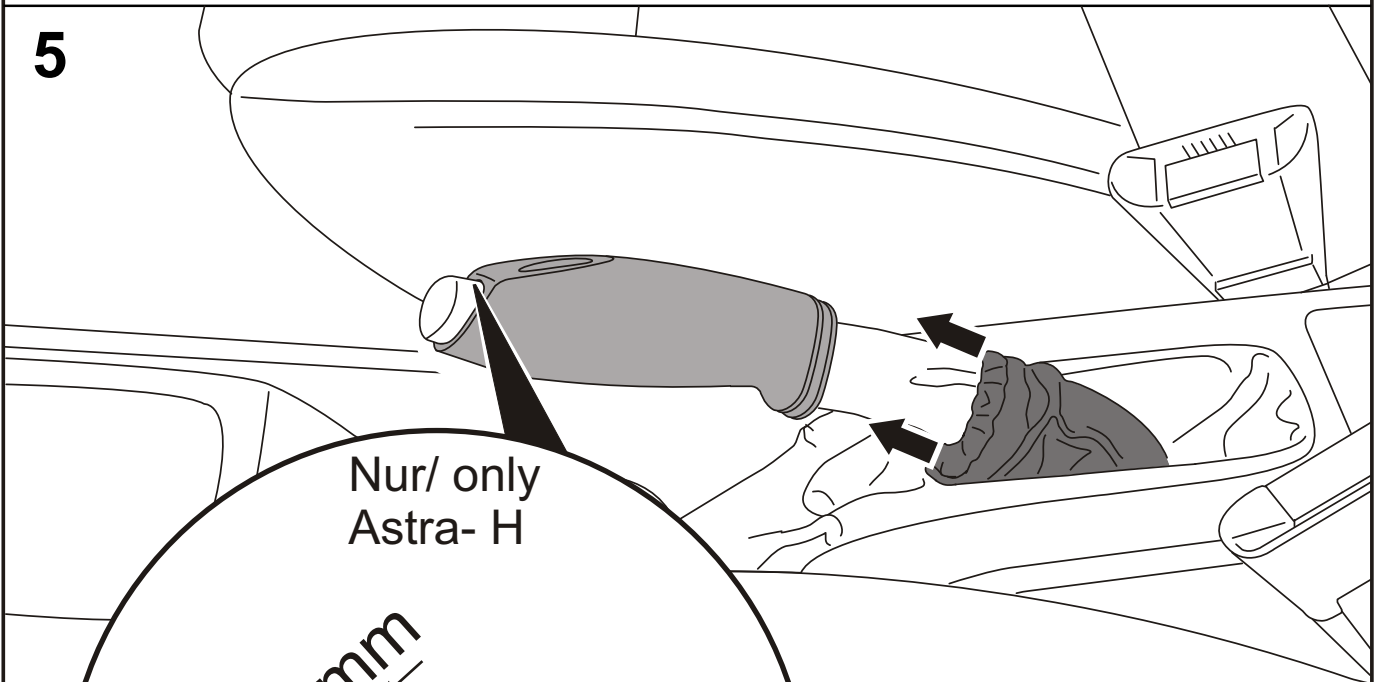

Nur/ only  
Astra- H

10 mm

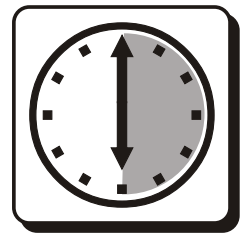
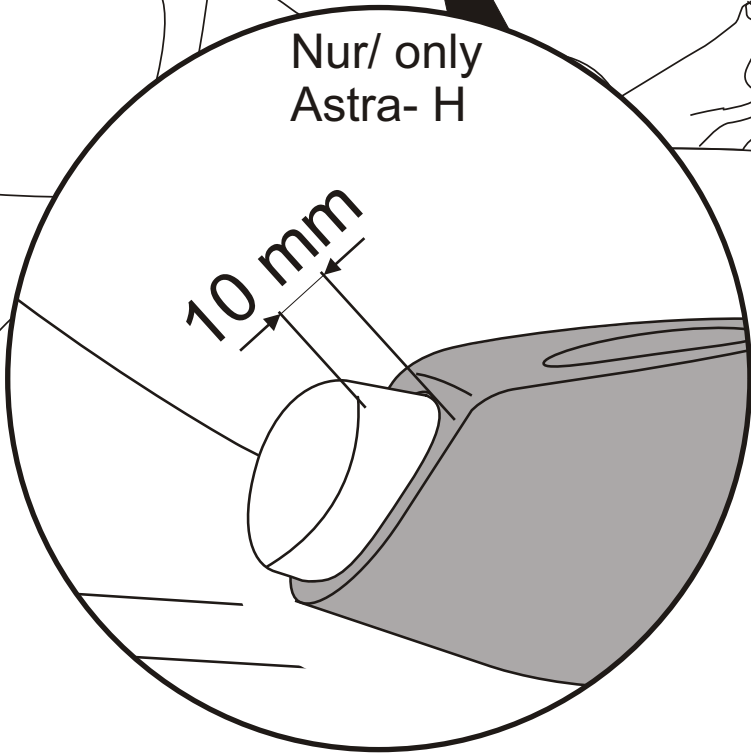

6h

6

